

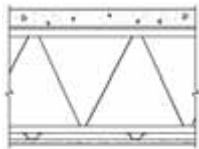

Gypsum Wallboard Floor/Ceilings – Steel Framing (steel joists with concrete floor) (CAD FILE NAME **GOLDP.DWG** OR **GOLDP.DXF** OR **GOLDR.DWG** OR **GOLDR.DXF**)

No.	Fire Rating	Ref.	Design No.	Description	STC	Test No.	IIC	
							No Carpet	Carpet & Pad
1	1 hr.	OSU	T-1936	5/8" (15.9 mm) Fire-Shield Gypsum Wallboard screw attached to furring channels spaced 24" o.c. (610 mm) attached to steel bar joists spaced 24" o.c. (610 mm). Concrete floor 2" (51 mm) thick.	53	Based on NGC 4075	21	67
	Based on NGC 5121						Based on NGC 5122	
	2 hr.	UL	G503	5/8" (15.9 mm) Fire-Shield Gypsum Wallboard or 5/8" (15.9 mm) Fire-Shield Kal-Kore plaster base screw attached to furring channels spaced 12" o.c. (305 mm) attached to or suspended from steel bar joists spaced 24" o.c. (610 mm). Concrete floor 2 1/2" (63.5 mm) thick.	53	(Direct) Based on NGC 4075	21	67
	Based on NGC 5121						Based on NGC 5122	
					57	(Susp.) Based on NGC 4078	28	75
							Based on NGC 5126	Based on NGC 5127

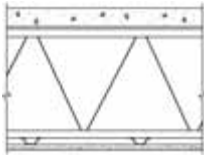
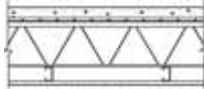
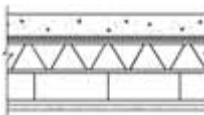
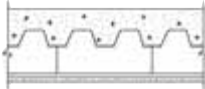
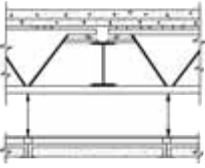

No.	Fire Rating	Ref. Design No.	Description	STC	Test No.		IIC	
							No Carpet	Carpet & Pad
2	2 hr.		UL G514 GA FC 2030	1/2" (12.7 mm) Fire-Shield C Gypsum Wallboard or 1/2" (12.7 mm) Fire-Shield C Kal-Kore plaster base screw attached to furring channels spaced 24" o.c. (610 mm) attached or suspended from steel bar joists spaced 24" o.c. (610 mm) with wire ties spaced 48" (1219 mm). Concrete floor 2 1/2" (63.5 mm) thick.	53	(Direct) NGC 4075	21 NGC 5121	67 NGC 5122
					57	(Susp.) Based on NGC 4078	28 Based on NGC 5126	75 Based on NGC 5127
	3 hr.		UL G512 GA FC 3012	5/8" (15.9 mm) Fire-Shield C Gypsum Wallboard screw attached to furring channels spaced 24" o.c. (610 mm) attached to steel bar joists spaced 24" o.c. (610 mm) with wire ties. Concrete floor 2 1/2" (63.5 mm) thick.	53	Based on NGC 4075		
3	1 hr.		FM GA FC-134 FC 1105	1/2" (12.7 mm) Fire-Shield C Gypsum Wallboard applied across 3 5/8" (92.1 mm) steel studs 24" o.c. (610 mm) with drywall screws 12" o.c. (305 mm). Studs wire-tied 8" o.c. (2440 mm) to steel bar joists spaced 24" o.c. (610 mm). 3/8" (9.5 mm) rib metal lath supporting 2 1/2" (63.5 mm) thick concrete slab.	52	Based on NGC 4075	21	67
4	2 hr.		UL G523	Single layer 1/2" (12.7 mm) Fire-Shield C Gypsum Wallboard or 1/2" (12.7 mm) Fire-Shield C Kal-Kore plaster base screw applied perpendicular to cross tees of a drywall suspension system that is suspended from steel bar joists 24" o.c. (610 mm), 2 1/2" (63.5 mm) concrete floor over 3/8" (9.5 mm) rib lath.	est. 50			
5	2 hr.		UL D502	Single layer of 5/8" (15.9 mm) Fire-Shield C Gypsum Wallboard screw applied perpendicular to the cross tees of a drywall suspension system suspended from a steel deck. Concrete floor 2 1/2" (63.5 mm) thick.	est. 50			
6	2 hr.		UL G222 FM FC-299 GA FC- 2190	Nominal 2' x 2' (610 mm x 610 mm) x 1/2" (12.7 mm) Fire-Shield G Gypsum Boards laid in fire-rated metal grid suspension system supported by hanger wire from steel joists supporting 2 1/2" (63.5 mm) concrete.				
	1 1/2 hr.		UL G259 FM FC-300 GA FC-1290	Nominal 2' x 4' (610 mm x 1219 mm) x 1/2" (12.7 mm) Fire-Shield G Gypsum Boards laid in fire-rated metal grid suspension system supported by hanger wire from steel joists supporting 2 1/2" (63.5 mm) concrete.				

QUICK SELECTOR FOR FIRE AND SOUND RATED SYSTEMS

Gypsum Wallboard Roof/Ceilings – Light Gauge Steel Framing (pitched roof truss) (CAD FILE NAME **GOLDP.DWG** OR **GOLDP.DXF** OR **GOLDR.DWG** OR **GOLDR.DXF**)

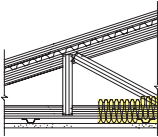
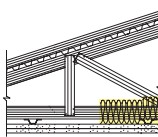
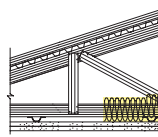
No.	Fire Rating	Ref.	Design No.	Description	STC	Test No.	IIC
1	1 hr.	UL GA	P540 RC-2501	 <p>One layer 5/8" (15.9 mm) Fire-Shield C Wallboard attached to 1/2" (12.7 mm) resilient furring channels screw fastened perpendicular to lower chord of light gauge steel trusses spaced a maximum 48" o.c. Roofing system UL Class A, B or C.</p> <p>Optional, mineral wool or glass fiber insulation draped over furring channels.</p>			
2	1 hr.	UL	P541	 <p>Two layers 5/8" (15.9 mm) Fire-Shield Wallboard attached to 1/2" (12.7 mm) resilient furring channels screw fastened perpendicular to lower chord of light gauge steel trusses spaced a maximum 48" o.c. Roofing system UL Class A, B or C.</p> <p>Optional, mineral wool or glass fiber insulation draped over furring channels.</p>			
3	2 hr.	UL	P543	 <p>Two layers 5/8" (15.9 mm) Fire-Shield C Wallboard attached to 1/2" (12.7 mm) resilient furring channels screw fastened perpendicular to lower chord of light gauge steel trusses spaced a maximum 48" o.c. Roofing system UL Class A, B or C.</p> <p>Optional, mineral wool or glass fiber insulation draped over furring channels.</p>			