

# PROFORM<sup>®</sup>

BRAND

## Drywall Finishing Products

### Gypsum Board Finishing and Repair Guide

#### Description

National Gypsum produces a complete line of joint treatment compounds and reinforcing tapes for the proper finishing of gypsum board joints. To ensure best results, only National Gypsum products should be used together in construction systems. Mixing of other brands is not recommended.

ProForm brand is a family of premium joint compounds formulated specifically for drywall finishing. All ProForm joint compounds deliver high performance relative to: less shrinkage, sandability, workability with less "pull," greater crack resistance, wet edge and open time, and hand or tool application.

#### Planning Ahead

- Carpenter's hammer
- Large straightedge or Wallboard T-square
- Utility knife for scoring wallboard
- 6", 8" and 12" finishing knives
- Pencil
- Keyhole or utility saw
- Plastic pan for joint compound
- 100 to 150 grit sandpaper
- Sponge
- Caulking gun
- Panel adhesive
- Safety goggles
- Dust mask

#### Estimating Materials

Quickly determine how much ProForm<sup>®</sup> BRAND Joint Compound will be needed to complete your project.

Sq. Ft. of Wall/Ceiling	Wallboard Size			Ready Mix /lbs.	Joint Tape /ft.	Sta-Smooth /lbs.
	4'x8'	4'x10'	4'x12'			
100	4	3	3	14	35	6
200	7	5	5	26	70	11
300	10	8	7	42	105	17
400	13	10	9	56	140	22
500	16	13	11	70	175	28
1000	32	25	21	140	350	55

#### Joint Compound Drying Time Guide

Approximate Drying Times: All Purpose/Lite Ready Mix Joint Compound

R.H.	Temperature						
	32°	40°	50°	60°	70°	80°	100°
0%	38/H	28/H	19/H	13/H	9/H	6/H	3/H
20%	2/D	34/H	23/H	16/H	11/H	8/H	4/H
40%	2.5/D	44/H	29/H	20/H	14/H	10/H	5/H
50%	3/D	2/D	36/H	24/H	17/H	12/H	6/H
60%	3.5/D	2.5/D	42/H	29/H	20/H	13.5/H	8/H
70%	4.5/D	3.5/D	2.25/D	38/H	26/H	19.5/H	10/H
80%	7/D	4.5/D	3.25/D	2.25/D	38/H	27/H	14/H
90%	13/D	9/D	6/D	4.5/D	3/D	49/H	26/H
98%	53/D	37/D	26/D	18/D	12/D	9/D	5/D

NOTE: R.H.= Relative Humidity D = Days (24 hour period) H = Hours  
The chart above is a helpful guide in determining approximate drying times for joint compounds under a variety of humidity/temperature conditions. Shaded area is below the minimum application temperature requirement of 50°F and is not recommended for the application of joint compound.

CAUTION: Be sure to apply joint compound at temperatures above 50°F with adequate ventilation to assure proper drying. Protect the joint compound from freezing.

#### Choose The Best Joint Treatment Brands For Your Project.

When you want to:	Embed Tape	Fill or Trim Cornerbeads	Finish Joints	Spot Nails & Screws	Texture	Skim Coat	Do Repair Work
You want:	Good Tape Bond	Low Shrinkage	Low Shrinkage	Low Shrinkage, Easy Sanding	Good Bond, Low Shrinkage	Smooth Float, Easy Sanding	Quick Set, Low Shrinkage
ProForm <sup>®</sup> Ultra	BEST	BEST	BEST	BEST	BEST	BEST	BEST
ProForm <sup>®</sup> All Purpose	BEST	GOOD	GOOD	GOOD	BETTER	BETTER	BETTER
ProForm <sup>®</sup> Multi-Use	BETTER	BETTER	BETTER	BETTER	GOOD	BETTER	BETTER
ProForm <sup>®</sup> Lite	GOOD	BEST	BETTER	BEST	GOOD	BETTER	GOOD
ProForm <sup>®</sup> Sta-Smooth <sup>®</sup> Dry Compounds	BETTER	BETTER	GOOD	GOOD	Not Recommended	Not Recommended	BEST



**ProForm<sup>®</sup> BRAND Ultra<sup>™</sup> Ready Mix Compound** is an innovative product that combines the excellent bonding characteristics of an all purpose with the superb sanding characteristics of a multi-use or midweight. Approximately 50% lighter than and shrinks 50% less than conventional ready mix.



**ProForm<sup>®</sup> BRAND All Purpose Ready Mix Compound** is designed for tape application, spotting of fasteners, drywall trim and complete joint finishing of wallboard.



**ProForm<sup>®</sup> BRAND Multi-Use Compound** is a midweight formula for the professional drywall finisher. It is designed for all phases of wallboard finishing: taping, spotting of fasteners, joint finishing, drywall trims and texturing.



**ProForm<sup>®</sup> BRAND Lite Ready Mix Compound** is approximately 30% lighter than conventional ready mix, sands easier and reduces shrinkage up to 20%. Designed for tape application, spotting of fasteners, drywall trim and complete joint finishing.



**ProForm<sup>®</sup> BRAND Sta-Smooth Lite Setting Compound** is a quick setting/hardening compound that is not affected by humidity once it has set and dried. Can be recoated as soon as previous coat sets and allows for same-day joint finishing.

#### Finishing Wallboard Joints

Finishing a wallboard joint is relatively simple if you follow these basic instructions:

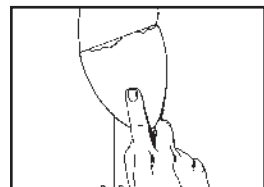

- Apply a uniform layer, 4" wide, of compound to the joints.

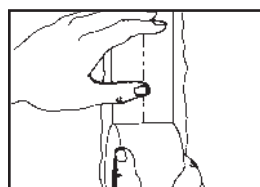

- Center tape over the joint and press firmly into place with the knife.
- Remove excess joint compound, leaving a sufficient amount under tape for adhesion to wallboard.
- Let joint dry for approximately 24 hours.

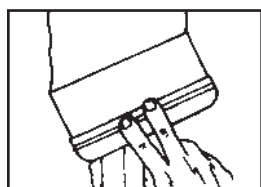

- First finish coat: Apply a thin coat of compound. Feather out 3" to 4" on each side of the tape. Let dry thoroughly (approximately 24 hours).
- Second finish coat: Apply a second thin coat. Feather out 8" to 10" on each side of the tape. Let dry approximately 24 hours.
- Sand compound with a damp sponge and blend with existing surface. Prime before decorating.

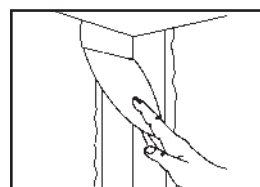

- Inside Corners**
- Apply 2" band of joint compound to both sides of inside corner. Crease tape along score line and press firmly into corner.
  - Remove excess joint compound, leaving a sufficient amount under tape for adhesion to wallboard.
  - Apply finish coat to one side of corner. Allow to dry. Then apply finish coat to the other side of corner. Allow to dry.

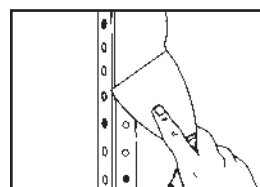

- Outside Corners**
- Cornerbead should be fastened securely 8" o.c. with fasteners on alternating sides.
  - Apply joint compound over the cornerbead flange. First coat should be approximately 4" wide; second coat 6" to 10" wide on each side of corner.

#### Repairing Cracks and Holes

##### Things To Remember Before You Get Started.

- Joint compound may require slight mixing.
- Remove loose or blistered paint, wallcovering, wallboard paper, or plaster from damaged surfaces.

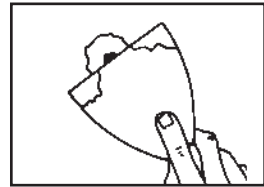

##### To Repair Cracks And Holes Smaller Than 1" In Diameter

- Cover the crack or hole with a uniform layer of joint compound.
- Cut tape larger than the hole; center tape over crack or hole and press tape into the joint compound.

- Remove excess compound, leaving a sufficient amount under the tape to allow adhesion to wallboard.
- Cover with a uniform layer of joint compound and let dry 24 hours.
- Sand with a damp sponge to level surface.

- Sand with a damp sponge to level surface.

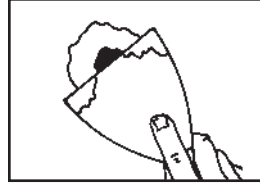

##### Repairing Cracks And Holes Larger Than 1" In Diameter

- (Do not attempt to patch holes larger than 2-1/2" in diameter)
- Cover the crack or hole with a uniform layer of joint compound.
  - Cut paper tape to horizontally bridge the crack or hole. Center tape over the crack or hole and press tape into the joint compound.

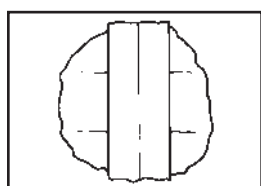

- Remove excess compound, leaving a sufficient amount under the tape to allow adhesion to wallboard.
- Apply joint compound over the first piece of paper tape.
- Place second piece of tape vertically over the first in a criss-cross pattern. Press the tape into the joint compound.
- Remove excess joint compound.
- Cover with a uniform layer of joint compound and let dry 24 hours.
- Apply a final coat if the tape is still visible beneath the compound.
- Sand with a damp sponge and blend with existing surface.
- Prime before decorating.

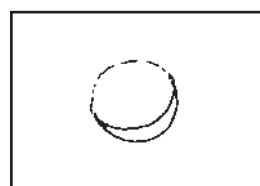

##### Repairing Popped Nails

A protrusion or bump in the wallboard surface directly over a nailhead is called a "nail pop." The nail has pulled away from the joist or stud.

- Drive a new nail 1-1/2" above the popped nail, into the stud. When driving the nail, you want to indent the face paper without tearing it (called dimpling).

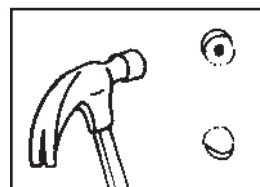

- Now drive and "dimple" the popped nail.
- Cover the slight depressions or "dimples" with joint compound and let dry 24 hours.

- Sand with a damp sponge and blend with existing surface.
- Prime before decorating.

##### Repairing Torn Face Paper

When the face paper of wallboard is torn, the wall is left rough and uneven. Repairing this situation is easy.

- Peel and remove all loose face paper.
- Coat damaged area with a primer/sealer using a paint brush.
- Apply Joint Compound to the damaged area and feather the edge to blend smoothly with the existing surface.
- Let dry approximately 24 hours.
- Apply a second coat if your repair is highly visible and let dry approximately 24 hours.
- Sand with a damp sponge and blend with existing surface.
- Prime before decorating.

#### Corporate Headquarters

National Gypsum Company  
2001 Rexford Road  
Charlotte, NC 28211

[nationalgypsum.com](http://nationalgypsum.com)

